

The 92nd Annual Meeting of the Japan Sociological Society

Day 1: October 5th (saturday), 2019

Day 2: October 6th (sunday), 2019

—Venue—

Tokyo Woman's Christian University

Cosponsored by Seikei University

Timetable

Friday October 4			
13:00 ~ 17:00	Business Meeting	Main Building Second Floor	Room 021
Saturday October 5			
8:30 ~	Registration Open	Main Building First Floor	Lobby
9:30 ~ 12:30	Regular Sessions		
12:40 ~ 13:20	Lunch Meeting for winners of travel grant	Building 7 Second Floor	Room 7206
13:20 ~ 14:30	General Assembly	Building 24 Second Floor	Room 2402
15:00 ~ 18:00	Regular Sessions		
19:00 ~ 20:30	Reception	KICHIJOJI TOKYU REI HOTEL	
Sunday October 6			
8:30 ~	Registration Open	Main Building Second Floor	Lobby
9:30 ~ 12:30	Regular Sessions		
	International Liaison Committee's Session	Building 6 Second Floor	Room 6215
10:30 ~ 13:00	Poster Session	Building 7 First Floor	Room 7102/7103
13:20 ~ 14:00	President Speech	Building 24 Second Floor	Room 24202
	Symposium 1	Building 23 Second Floor	Room 23201
14:10 ~ 17:40	Symposium 2	Building 24 Second Floor	Room 24202
	Symposium 3	Building 23 Second Floor	Room 23101

General Information

1. Registration Fee

General Member	6,000 JPY	Student Member	4,000 JPY
Non-Member	7,000 JPY	Student Non-Member	5,000 JPY

2. Reception Participation Fee

General Member	6,000 JPY	Student Member	3,000 JPY
----------------	-----------	----------------	-----------

3. The registration space is located in the lobby of the main building, 1st floor. Registration starts on Saturday, October 5 at 8:30 am.

4. Each participants will receive a name tag upon registration. For security reasons, please keep wearing your name tag to show you are registered person.

5. Cafeteria located on the northwest side of the building No.11 is open at lunch time during the conference.

6. If you have any problems, please contact us: konno@lab.twcu.ac.jp

Access Information

【To the Nearest Station】

The nearest station of Tokyo Woman's Christian University is "Nishi-Ogikubo" station along the Chuo Line & Sobu Line of JR east. Rapid Trains do not stop at Nishi-Ogikubo on weekends and holidays. Please use JR Sobu local trains.



【From Haneda Airport (about 1.5 hour to conference site)】



(<http://www.twcu.ac.jp/univ/english/about/access/>)

【From Narita Airport (about 2 hour to conference site)】

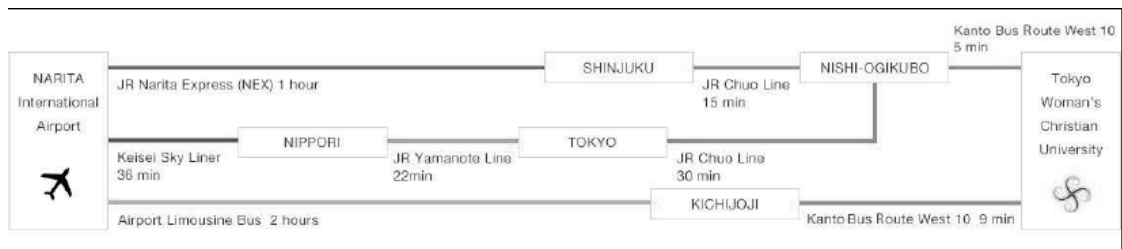

(<http://www.twcu.ac.jp/univ/english/about/access/>)

【From the Nearest Station】

It takes about 15 minutes to walk from Nishi-Ogikubo Station north gate. You are also available to ride a bus from there.

BUS TERMINAL: Terminal 1, North Gate

BUS ROUTE: WEST 10

For North Gate of Kichijoji Sta. via Tokyo Woman's Christian Univ.



Campus Map

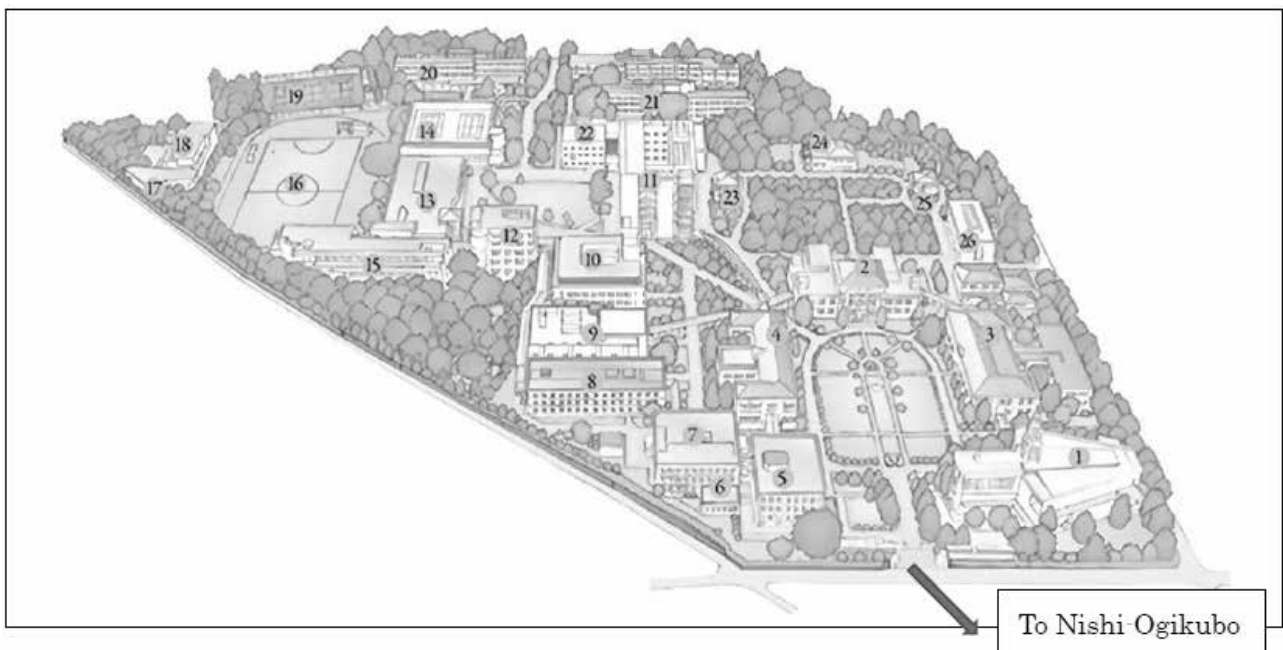

※The reception of conference is located in the Main building (NO. 2 in the map above).

本館

Main Building

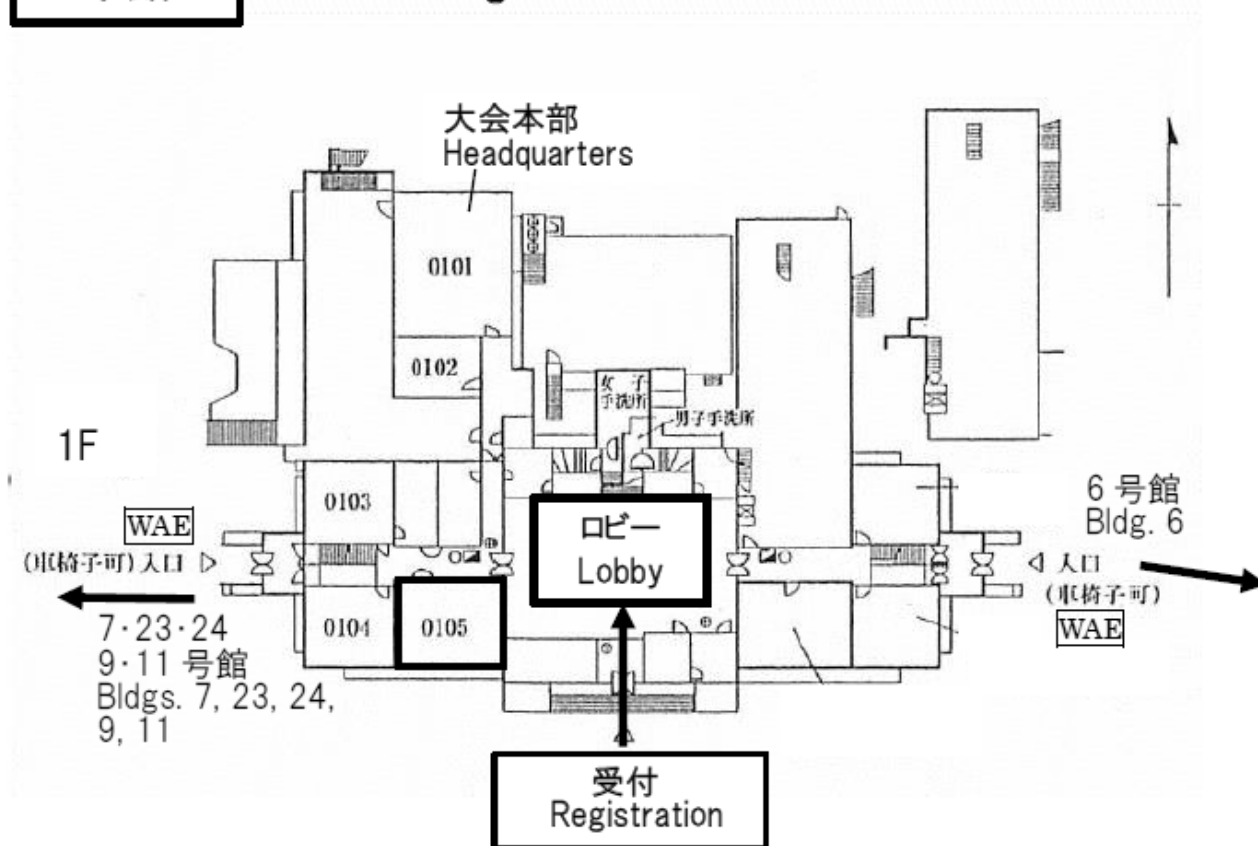

WAE: Wheelchair Accessible Entrance

受付

Registration Desk

事前振込済みの方

For Pre-registered Participants

本館ロビー

Lobby, Main Bldg.

当日お支払いの方

On-site Registration

本館 0105 教室

Room 0105, Main Bldg.

6 号館

Building No.6

2F

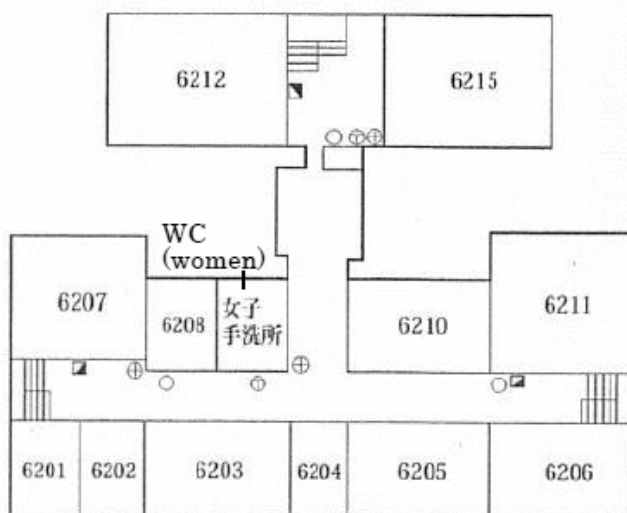

部会
Sessions

※6 号館にはエレベータは
ございません。
※No elevator in bldg. 6

1F



部会
Sessions

本館
Main Bldg.

入口
(車椅子可)
WAE

WAE
入口

WAE: Wheelchair Accessible
Entrance

多目的トイレ
Multipurpose Lavatory

中庭(芝生)
Lawn/Courtyard

正門
Main Gate

23・24・9・11 号館
Bldgs. 23, 24, 9, 11

7 号館
Bldg. 7

7 号館

Building No.7

2F

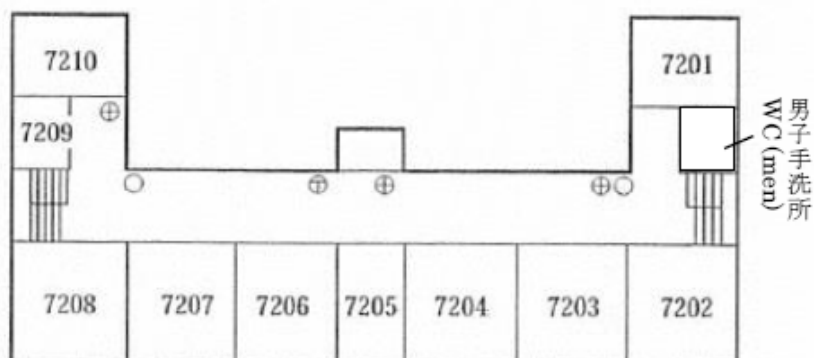

1F

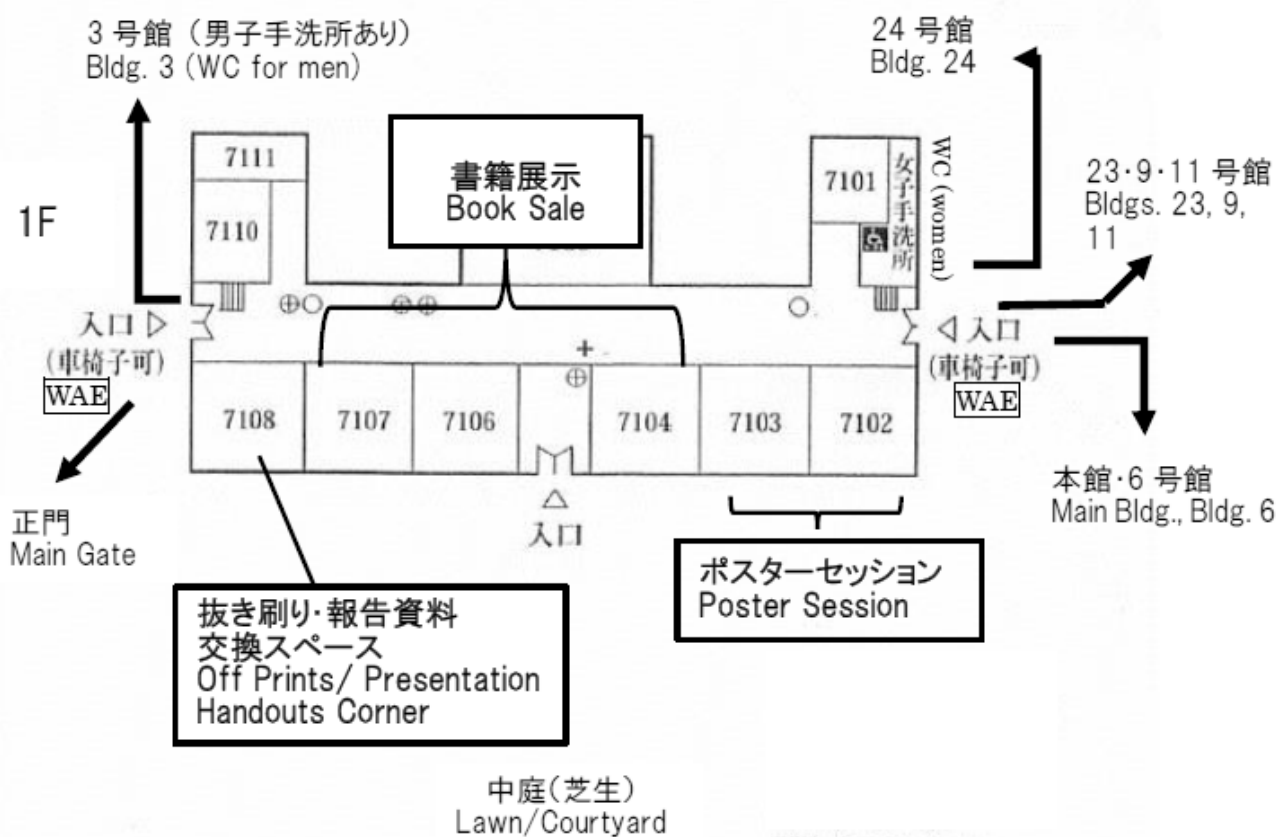

※7 号館にはエレベータは
ございません。

No elevator in bldg. 7

※3 号館男子手洗所も合
わせてご利用ください。

Please also use WC for
men in adjacent bldg. 3.

6 号館
Bldg. 6



多目的トイレ

Multipurpose
Lavatory

WAE: Wheelchair Accessible
Entrance

9 号館

Building No.9

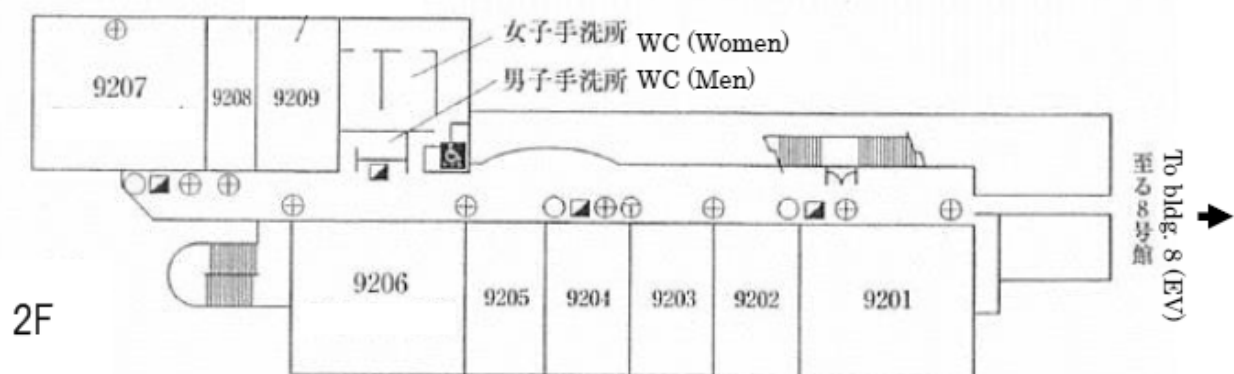

部会
Sessions

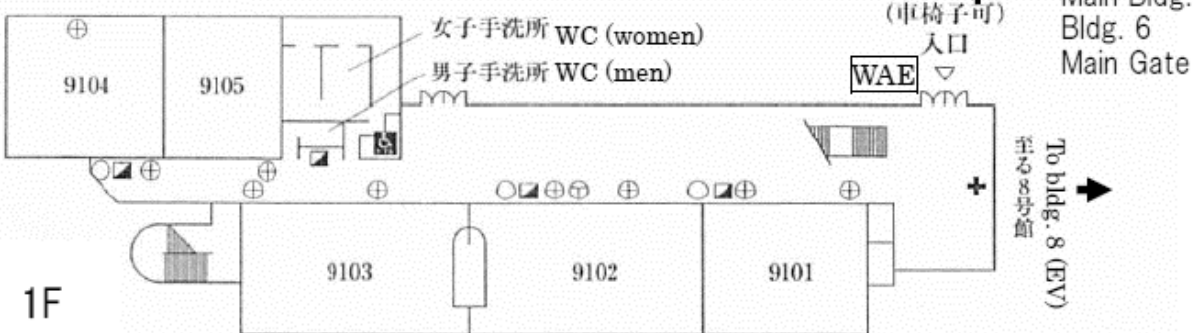

部会
Sessions

※8 号館（直結）のエレベータもご利用ください。
An elevator is available in bldg. 8 (directly connected).

 多目的トイレ
Multipurpose
Lavatory
 WAE: Wheelchair
Accessible Entrance

11 号館

Building No.11



2F カフェテリア営業時間
5 日 (土), 6 日 (日)
11:00~14:00

2F Cafeteria
Hours 11:00-14:00
Saturday 5th
& Sunday 6th

1F 参加者控室は両日とも終日 (9:00~17:00) お使いいただけます。

Lounge (1F) is open
9:00-17:00, Saturday
5th & Sunday 6th.

2F

※カフェテリア
(2F) へは階段もしくはエレベータをご利用ください。

To the cafeteria
(2F) please use the
stairs or the
elevator.

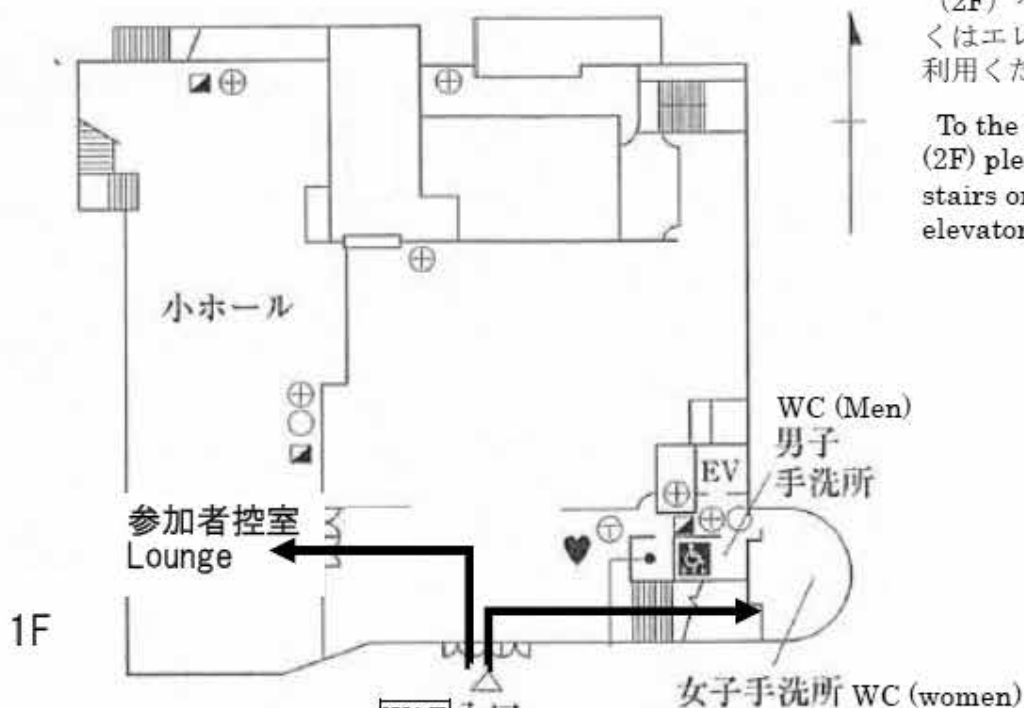

1F

WAE 入口
(車椅子可)

9 号館 Bldg. 9

23・24・7・6 号館
本館, 正門
Bldgs. 23, 24, 7, 6
Main Bldg.
Main Gate



多目的トイレ

Multipurpose Lavatory



WAE Wheelchair Accessible Entrance

23 号館

Building No.23

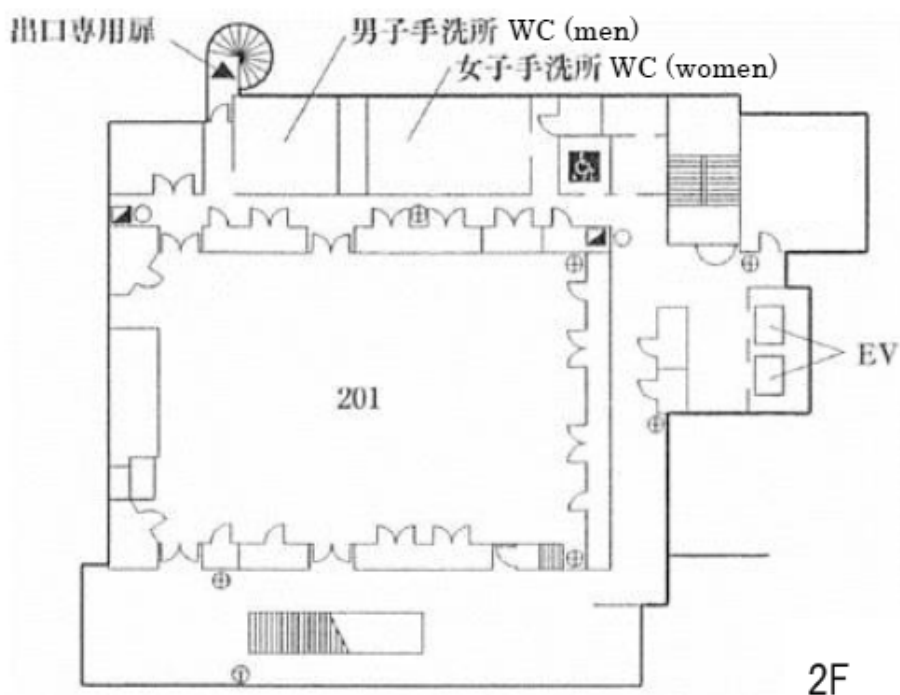

シンポジウム 1 Symposium 1

※男子手洗所は 24 号館, 3 号館も合わせてご利用ください。

Please also use WC for men in bldgs. 24 and 3.

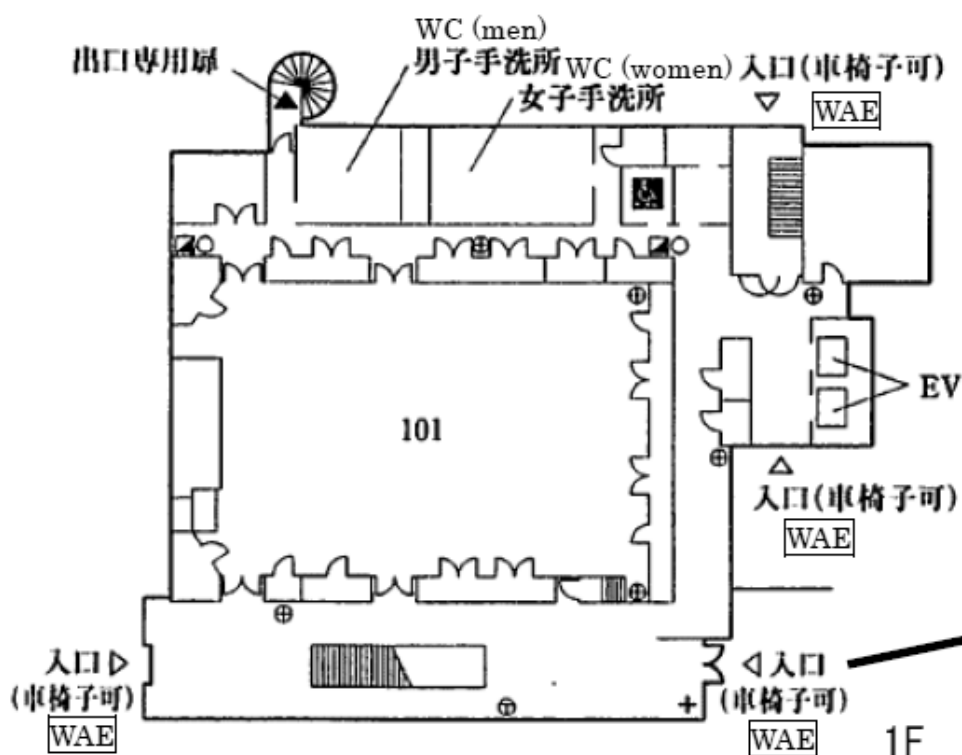

本館・正門
Main Bldg.
Main Gate

シンポジウム 3 Symposium 3

24・3 号館
本館・正門
Bldgs. 24, 3
Main Bldg.
Main Gate

多目的トイレ Multipurpose Lavatory

WAE: Wheelchair Accessible Entrance

24 号館

Building No.24

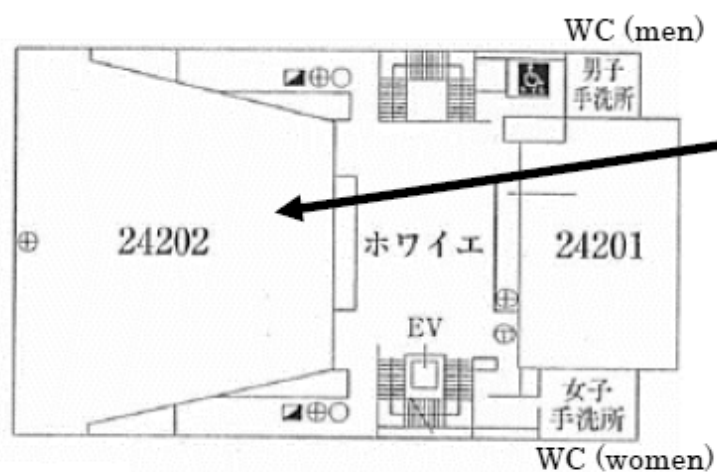

2F

5 日(土)

総会・式典
General Meeting/
Ceremony

受賞講演
Lecture Meeting

6 日(日)

会長講演
Presidential Address

シンポジウム 2
Symposium 2



1F

23・9・11 号館
Bldgs. 23, 9, 11

7 号館, 本館,
6 号館
Bldg. 7
Main Bldg.
Bldg. 6

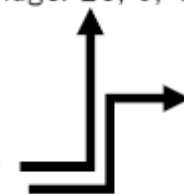

3・7 号館, 正門
Bldgs. 3, 7
Main Gate

 多目的トイレ
Multipurpose
Lavatory

WAE: Wheelchair Accessible Entrance

Information for presenters

1. During the annual meeting, photocopy and printing service is unavailable due to the lack of sufficient facilities. Please prepare your handouts in advance. It is recommend to bring about 50 copies of your handouts.
2. You should arrive at your session room at least 5 minutes before the starting time, and please talk to the chairperson with regard to time table and other arrangement.
3. Each paper must be presented in 15 minutes and discussion follows.
4. For PowerPoint presentations, an LCD projector and a screen will be available in each session room. Presenters are required to bring their own laptop computer. Mac users must bring the connector to adjust to standard Windows monitor cable. For preparation, please come to the session room 15 minutes before the starting time of the session.
5. You can find and exchange the handouts or discussion papers in the Room 7108, 1st floor of Buliding No. 7.
6. If you will withdraw your presentation, please contact us:
konno@lab.twcu.ac.jp and jss@sociology.gr.jp

Program Structure

Room No.	Saturday, October 5		Sunday, October 6
	9 : 30 ~ 12 : 30	15 : 00 ~ 18 : 00	9 : 30 ~ 12 : 30
	Regular Sessions (1)	Regular Sessions (2)	Regular Sessions (3)
【Building 6】 6105	Education	Social Movements	
6106	Social welfare, Health, Medical Care (1)	Social welfare, Health, Medical Care (2)	Social welfare, Health, Medical Care (3)
6110	Gender, Sexuality (1)	Gender, Sexuality (2)	Gender, Sexuality (4)
6112	Information, Communication	Gender, Sexuality (3)	Environment
6115	Ethnic Groups, Ethnicity (1)	Ethnic Groups, Ethnicity (2)	Ethnic Groups, Ethnicity (4)
6203	Discrimination, Minority	Ethnic Groups, Ethnicity (3)	Social Pathology
6205	Social History/Life History (1)	Social History/Life History (2)	Area Studies
6206	Theory of Sociology	History of Sociology	Politics, Power
6207	Class, Stratification, Mobility (1)	Class, Stratification, Mobility (2)	Class, Stratification, Mobility (3)
6210	Thematic Session (1)	Thematic Session (6)	Thematic Session (11)
6211	Thematic Session (2)	Thematic Session (7)	Thematic Session (12)
6212	Thematic Session (3)	Thematic Session (8)	Thematic Session (13)
6215	Thematic Session (4)	Thematic Session (9)	ILC's Thematic Session "New Migration Trends in East and Southeast Asia"
【Building 7】 7102			Poster Session 10:30-13:00
7103			Poster Session 10:30-13:00
【Building 9】 9101	Thematic Session (5)	Thematic Session (10)	
9102	Disaster (1)	Disaster (2)	Disaster (3)
9103	Culture, Social awareness (1)	Culture, Social awareness (2)	Culture, Social awareness (3)
9104	Industry, Labor, Organizations (1)	Industry, Labor, Organizations (2)	Industry, Labor, Organizations (3)
9105	Family (1)	Family (2)	Urban Studies
9201	Community (1)	Community (2)	Community (3)
9202	Methodology of Sociology (1)	Methodology of Sociology (2)	

 : Sessions in Japanese

Please check information of sessions in Japanese on the Web-Program
(<https://jss-sociology.org/meeting/20190823post-9421/>)

Titles of Papers

1st Day, Saturday, October 5

Regular Sessions (1) (9:30 ~ 12:30)

Information, Communication

Room 6112, Building No.6 (1st Floor)

Chairperson: TSUJI, Daisuke (Osaka University)

Facilitator: HIRAO, Keiko (Sophia University)

- | | | |
|--|--|---|
| 1 Gender Roles in Television Commercials in Asia: A Comparison of Japan, China, Taiwan, Korea, Thailand, and Singapore | Kyoto Sangyo University | Pongsapitaksanti, Piya |
| 2 Consideration of the age of monopolization by the information environment (architecture) | Tokyo Metropolitan University | INABA, Toshikazu |
| 3 Pre-beginnings for conversation openings in collective personal workplace | ○ University of Tokyo
National Diet Library
University of Tokyo
University of Tokyo
University of Tokyo
University of Tokyo
University of Tokyo
University of Tokyo
University of Tokyo
University of Tokyo | SAKAI, Eri
KAMESAWA, Akihiko
NAKAYAMA, Riko
KIM, Ji-Hoon
Akizuki, Yuri
Yang, Ying-Xue
OGINO, Ryogo
GOTO, Jun |
| 4 The Decline of railroads and the "Attractionification" of mobility itself: Research into tourist trains of rural rail lines in Japan | University of Tokyo | AHN, Eun-Byul |
| 5 Social Media in the Las Vegas Shooting: The Social Structure of Discourse in the Digital Public Sphere | University of Toronto | Anson Au |

Class, Stratification, Mobility (1)

Room 6207, Building No.6 (2nd Floor)

Chairperson: HOMMERICH, Carola (Hokkaido University)

Facilitator: KOBAYASHI, Jun (Seikei University)

1 "Because Hostesses Earn Easily": Interview Data Analysis of Class Strategy of Hostesses in Japan	Seikei University	KOBAYASHI, Jun
2 How Neoliberalism and Islamophobia shape schooling of Muslim minority students in Sydney	Western Sydney University	Zainab, Mourad
3 Discrimination, Exclusion and Erasure: Islamic Dress in Lebanon under Coloniality	University of Sussex	Ali, Kassem
4 New Forms of Discrimination? Re-examining the Online Discourses of Racial Discrimination on Airbnb	Hong Kong Baptist University	LI, Yao-Tai
5 Increasing College Graduates and Changes in the Effect of Education on Occupational Attainment	Niigata University	FURUTA, Kazuhisa
6 The Impact of Class Origin throughout the Life Course among Elderly People	○ Hitotsubashi University University of Tokyo	MUGIYAMA, Ryota SHIRAHASE, Sawako
7 The effect that a big gap of post of father and the child gives the social status evaluation	Kindai University	TSHUJI, Ryuhei
8 Shaping Stances: Three Decades of Trends in Young People's Attitudes towards Income Inequality and Redistribution	Kyoto University	KITSNIK, Joanna

Culture, Social awareness (1)

Room 9103, Building No.9 (1st Floor)

Chairperson: NISHIYAMA, Tetsuo (Kansai University)

Facilitator: TOMINAGA, Kyoko (Rithumeikan University)

1 A Structural Analysis of "Mystery Field" in Japan: A Case Study of "New Traditionalist" Movement in Detective Novel	Hosei University	YAMAGUCHI, Keita
2 A study on the practice of 2D(virtual) idol fans: A case of photography with goods such as stuffed toys	Waseda University	SHIMIZU, Akiko
3 Grasping fans by membership categorization analysis: From fans' daily interaction and conversation	Saitama University	YUAN, Jing-Long
4 Multi-modality in Musical Activities: Organizing Accountability through Musical Performances	Keio University	YOSHIKAWA, Yuki
5 Effect of Research as a foreign researcher	Nanzan University	KOBAYASHI, Sumiko
6 Looking at lifestyle and cultural-oriented migration from West to East: The case of Western potters in Japan	Tokyo Metropolitan University	MORAIS, Liliana

Industry, Labor, Organizations (1)

Room 9104, Building No.9 (1st Floor)
Chairperson: TAKAHASHI, Koji (JILPT)
Facilitator: KHOR, Diana (Hosei University)

- | | | |
|--|----------------------------------|--------------------------------|
| 1 What is the impact of late career transitions on workers' health in Japan?:
A longitudinal perspective using JSTAR-RIETI | Université libre
de Bruxelles | WELS,
Jacques |
| 2 The Effects of Ambiguous Position of Dispatched Workers on Relation
and Work Practices between Dispatched and Regular Workers in Office | University
of Tokyo | SHIBUYA,
Miwa |
| 3 Possibilities and Limitation for Skill Transfer in Technical Intern Training
Program: Case study of Indonesian Technical Intern Trainee | Hitotsubashi
University | WAODE,
Hanifah
Istiqomah |
| 4 The Mechanism of Power in the Interview on Returning to Work from
Child-care Leave: The Exploitation of Anxiety | Saitama Gakuen
University | SUGIURA,
Hiromi |
| 5 Building Caring Democracy: Comparison of Social Movement of Child
Care Workers in Japan and United States | Shimonoseki City
University | HAGIWARA,
Kumiko |

1st Day, Saturday, October 5 Regular Sessions (2) (15:00 ~ 18:00)

Social welfare, Health, Medical Care (2)

Room 6106, Building No.6 (1st Floor)
Chairperson: MATSUSHIGE, Takuya (NIPH)
Facilitator: HOSODA, Miwako (Seisa University)

- | | | |
|---|-----------------------------------|------------------------|
| 1 Trends and Challenges of Migrant Nurses in Japan: Some Indications
from Canada and Australia | Seisa
University | HOSODA,
Miwako |
| 2 Research on the implications of clinical trials for patients with refractory
disease: Based on interviews with patients of HTLV-1 related diseases | Yamaguchi
University | KUWAHATA,
Youichiro |
| 3 Re-evaluating the Miyako method in terms of life-stories of an ex-patient
of the Leprosy Sanatorium Miyako Nanseien | Matsuyama
University | YAMADA,
Tomiaki |
| 4 Morality in Nutrition Science in The Early Modern Japanese Society | University
of Tsukuba | SATOU,
Chinami |
| 5 Overdiagnosis: What Does Artificial Intelligence-Assisted Medical Testing
Offer? | Kobe City College of
Nursing | KASHIDA,
Yoshio |
| 6 Double responsibilities of inter-generational care and institutional injus-
tice: From policy analysis and case study in Japan and Korea | ○ Yokohama
National University | SOUMA,
Naoko |
| 7 Not to tell my daughter that she is a carrier with SBMA | University
of Bristol | YAMASHITA,
Junko |
| | University
of Tokyo | KIYA,
Yukitaka |

Class, Stratification, Mobility (2)

Room 6207, Building No.6 (2nd Floor)

Chairperson: TSUJI, Ryuhei (Kindai University)

Facilitator: ISHIDA, Hiroshi (University of Tokyo)

- | | | |
|--|--|---|
| 1 Acceptance and Legitimization of Income Inequality in Japan, South Korea, and the United States (1): Survey Design and the Determinants of Just Income | Shizuoka University | YOSHIDA, Takashi |
| 2 Acceptance and Legitimization of Income Inequality in Japan, South Korea, and the United States (2): Institutional Settings of Employment Systems and Work-Related Attitudes | Tohoku Gakuin University | KANBAYASHI, Hiroshi |
| 3 Acceptance and Legitimization of Income Inequality in Japan, South Korea, and the United States (3) : Over-acceptance of Inequality by People in Disadvantageous Positions | University of Tokyo | ARITA, Shin |
| 4 The Mechanism Underlying Entrance into Family Employment in Japan: Using the SSM Survey Data of 2005 and 2015 | Osaka University | HIRAO, Ichiro |
| 5 Unignorable controlled variable effect of gene single nucleotide polymorphism rs53576 on hierarchical assignment awareness-a discovery of "Twitter gene"? | ○ Kagoshima University
Kagoshima University
University of Tokyo
Nara University
Kagoshima University | SAKURAI, Yoshio
NISHITANI, Atsushi
AKAGAWA, Manabu
ONOE, Masato
ATAKA, Koji |
| 6 Fathers' use of family public policies in Japan and Quebec Province | University Laval | Valerie, Harvey |
| 7 The Paradox of the Super-Overstaying Migrants: Critical Realist Causality in Human Mobility | Loughborough University | Joselito Ranara, Jimenez |

2nd Day, Sunday, October 6

Regular Sessions (3) (9:30 ~ 12:30)

Gender, Sexuality (4)

Room 6110, Building No.6 (1st Floor)

Chairperson: SHINGAE, Akitomo (Osaka City University)

Facilitator: TAKAMARU, Rika (Kagoshima University)

- | | | |
|--|------------------------------------|----------------------------------|
| 1 An Introduction to Research on Sexual Minorities and Poverty | Waseda University | SHIDA, Tetsuyuki |
| 2 A Study on Solidarity of Sexual Minorities | Kyushu University | INOUE, Satoshi |
| 3 Cultural politics of queer migration | Kobe University | HUGHES, Phillip |
| 4 Formation of the categories for ambiguous gender-nonconformity: Focusing on "X-jenda" in Japan | University of Tokyo | TAKEUCHI, Kyoko |
| 5 Outside of identity politics and risk management: The stories of Japanese cross-dressers and the cisgender males attracted to them | Toyo University | ISHII, Yukari |
| 6 Asking about Sexual Orientation and Gender Identity in Social Surveys: Case Report on the Osaka City Residents' Survey and Related Preparatory Studies | ○ IPSS
University of Washington | KAMANO, Saori
HIRAMORI, Daiki |
| 7 How to Measure the Proportion of the Transgender Population? : On the 'Osaka City Residents' Survey' and the '2017 Study of Attitudes Regarding Office Restrooms for All-Gender Use' | Kanazawa University | IWAMOTO, Takeyoshi |
| 8 Inequality of Socioeconomic Status Based on Sexual Orientation and Gender Identity in Japan: Findings from the Osaka City Residents' Survey | University of Washington | HIRAMORI, Daiki |

Ethnic Groups, Ethnicity (4)

Room 6112, Building No.6 (1st Floor)

Chairperson: SUZUKI, Eriko (Kokushikan University)

Facilitator: MAZUMI, Yusuke (Kanazawa University)

- | | | |
|---|---------------------------------|--------------------|
| 1 Special permission for residence toward undocumented migrants who married in Japan: How the marriage is evaluated as 'stable and mature'? | JSPS | KATO, Jotaro |
| 2 Reconceptualization of the social entrepreneurship of the return emigrant | Kyoto Sangyo University | SAWAI, Shiho |
| 3 Why Is the Migrant Population Growing in Non-Large Urban Cities of Economically Developed Countries?: An Analysis of Processes of the Migrant Employment in Food Industries from a Global Perspective | Kanazawa University | MAZUMI, Yusuke |
| 4 Japaneseness in Overseas Japanese Companies: Dynamics Shaping Working Practices of Locally Hired Workers | Doshisha University | MATSHUTANI, Minori |
| 5 An Ethnography of International Student Service Workers | Hitotsubashi University | PAK, Ji-Won |
| 6 The Technical Intern Trainees as human resources for Vietnam's economic growth: Management strategies of sending organizations in Ho Chi Minh | ○ Notre Dame Seishin University | NIKAIDO, Yuko |
| 7 The Hope of Vietnamese Young People for Japanese Technical Intern Training Program and Its Estimation | Okayama University | DADAI, Hisashi |
| | ○ Okayama University | DADAI, Hisashi |
| | Notre Dame Seishin University | NIKAIDO, Yuko |
| 8 African Football Players in Southeast Asia: Their Strategy for Survival | Otani University | ABE, Toshihiro |

ILC's Thematic Session "New Migration Trends in East and Southeast Asia"

Room 6115, Building No.6 (1st Floor)

Chair: Takaya Sachi (Osaka University), Piya Pongsapitaksanti (Kyoto Sangyo University)

Opening remarks by Ochiai Emiko, the head of the JSS International Liaison Committee

Discussants: Lan Pei-Chia (National Taiwan University), Ogaya Chiho (Ferris University)

- | | | |
|---|--|-----------------|
| 1 Japanese Migration Policy Reform and Complexity of Channels: From Control Orientation to Rights Based Laissez-Faire | Kyoto University | Asato, Wako |
| 2 Transforming Exclusionary Migration Regime?: New Economic Migration Policy in Taiwan | National Taiwan University | Tseng, Yen-Fen |
| 3 Sending more or sending better care workers abroad?: A dilemma of Vietnam labour exporting strategy | Institute for Social Development Studies | Khuat, Thu-Hong |
| 4 Environmental Migration, Human Security and Climate Refugees in Philippine Cities | Ateneo de Manila University | Emma, Porio |